

1.

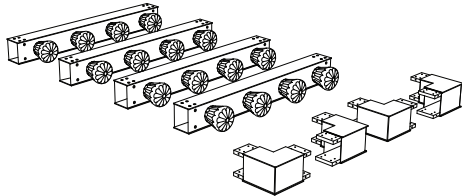

Carefully unpack the light fixture. Your set might be pre-assembled depending on the complexity of the light fixture.

2.

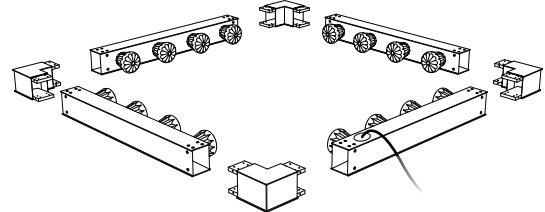

Align all parts on a clean flat surface. Locate the electricity cables inside all parts.

3.

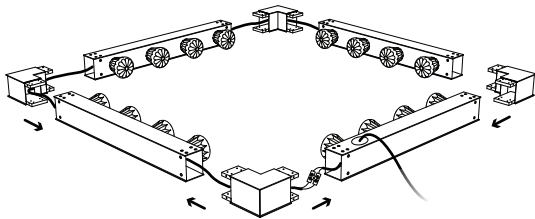

Connect all electricity cables from part to part starting from the bar with the main electric wire that will be connected to the house electricity wire afterwards.

4.

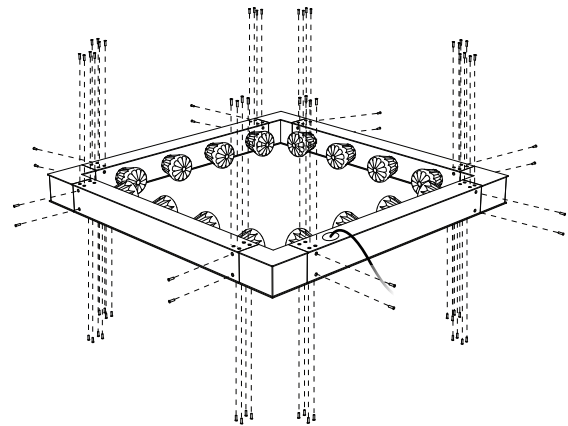

Carefully tuck all the cables inside the lamp and join all parts of the fixture. Fix the parts with the included screws.

CONTACT

JSPR
T +31 (0) 402692111
INFO@JSPR.EU
WWW.JSPR.EU

1.

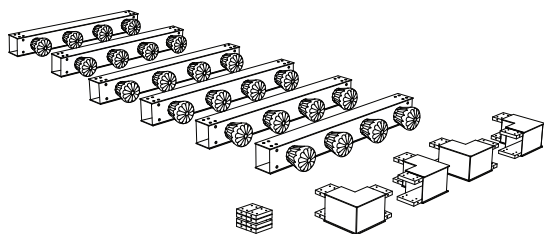

Carefully unpack the lighting fixture. Your set might be pre-assembled depending on the complexity of the light fixture.

2.

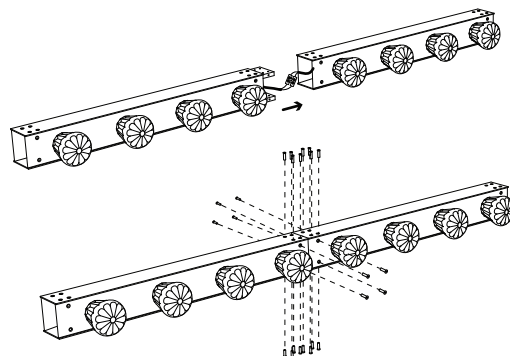

Align all the light bars to each other. Connect the electricity cable between each bar and assemble them using the provided extension blocks. Fix with included screws.

3.

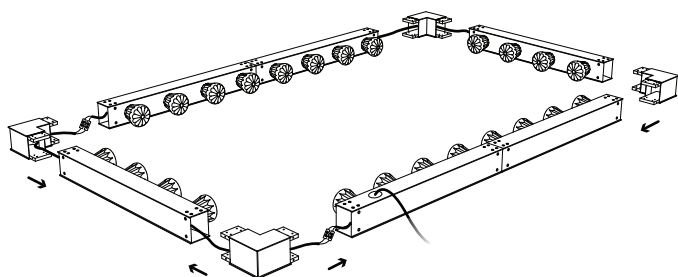

Align the newly connected bars to the remaining parts. Locate the electricity cables and connect them through out the lamp, starting from the bar with the main electric wire that will be connected to the house electricity wire afterwards.

4.

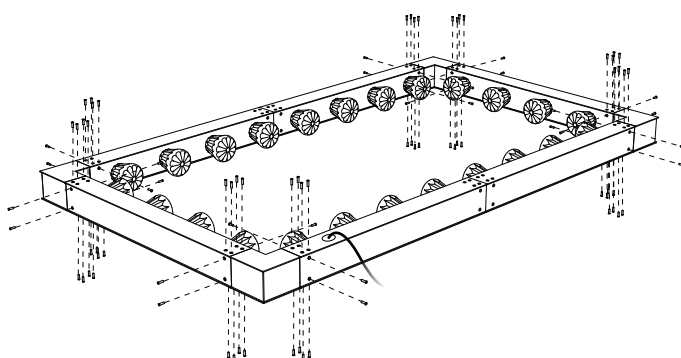

Carefully tuck all the cables inside the lamp and join all parts of the fixture. Fix the parts with included screws.

CONTACT

JSPR
T +31 (0) 402692111
INFO@JSPR.EU
WWW.JSPR.EU

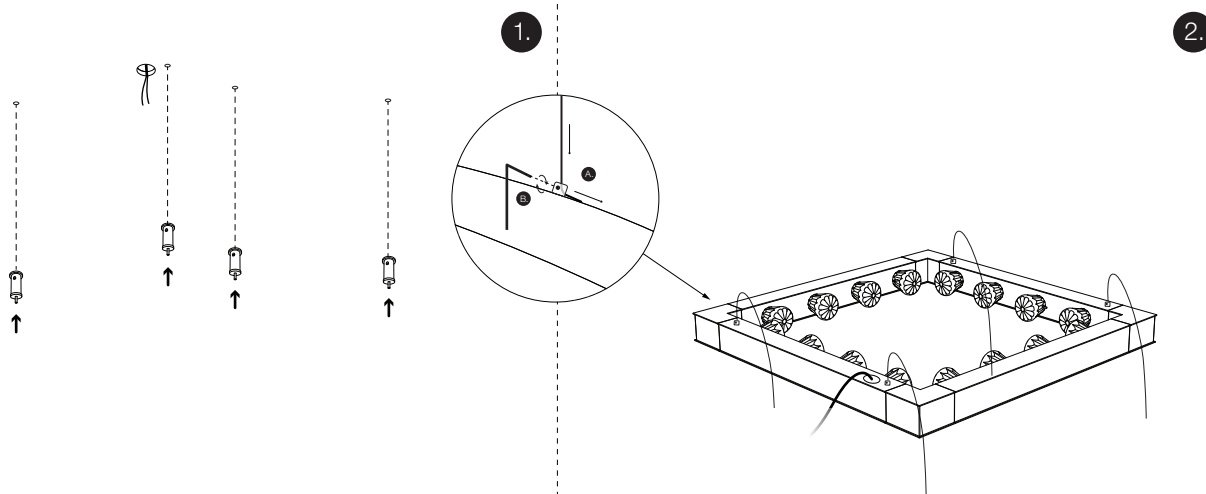

Mark and drill holes in the ceiling based on lamp measurements. Attach JSPR suspension cable fasteners positioning one near the house electricity wire.

NOTE: Installation and use of our ceiling suspension cable fasteners is enclosed in this document.

Locate all cable fasteners on the top of the lamp. Uncoil the provided suspension cables and guide them through the **top** of each fastener (**A**). Fasten the cable using a hex key (**B**). Trim any excess cables.

NOTE: Make sure to tighten the fasteners very well and always use all cable fasteners that are strategically placed on the fixture to avoid any damage.

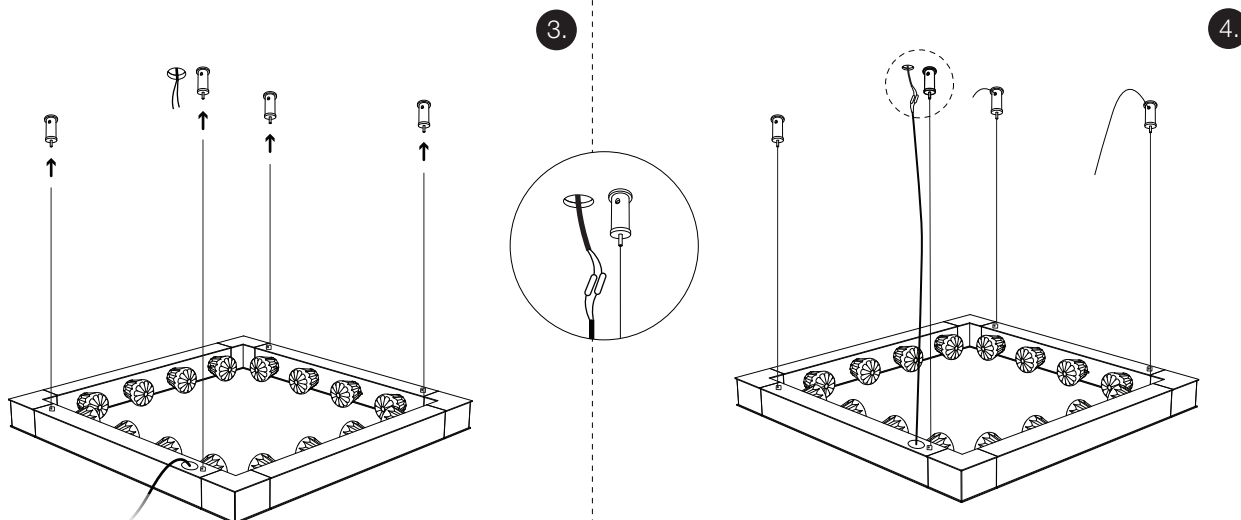

Guide the lamps suspension cables through the pre-mounted ceiling fasteners until desired length is achieved.

Trim any excess cables.

Manual on using our cable fasteners is enclosed in this document.

Shorten the electric wire and connect it to the house wire. Use splices and heatshrink. Tuck away any excess wires and trim suspension cables if necessary.

CONTACT

JSPR
T +31 (0) 402692111
INFO@JSPR.EU
WWW.JSPR.EU

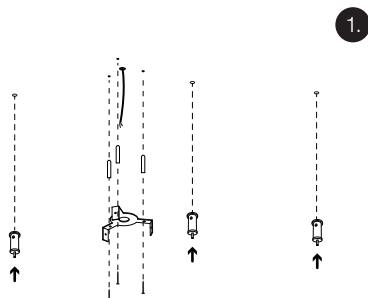

Mark and drill holes in the ceiling near the house electricity wire, based on the canopy size. Attach canopy base plate and two suspension fasteners using screws and dowels (by client).

NOTE: detailed information on mounting and using our suspension cable fasteners is enclosed in the next pages.

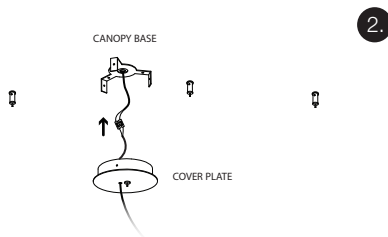

Shorten the lamps electricity wire approximately the desired length leaving a bit extra. Connect house wire to lamp electricity wire using a connection block.

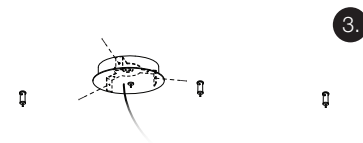

Align and fix the cover plate to the pre-mounted canopy base with three provided screws.

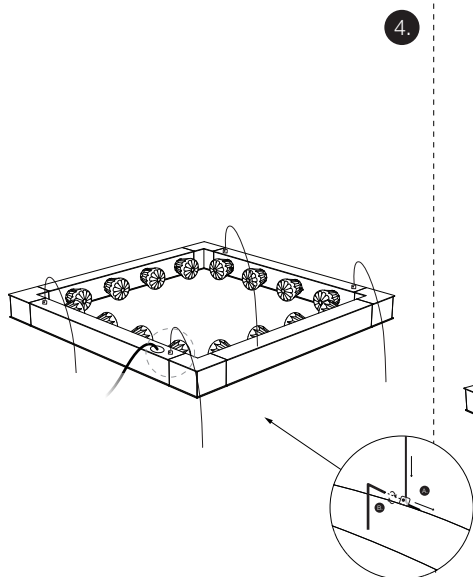

Locate cable fasteners on the top of the fixture. Uncoil the provided suspension cables and guide them through the **top** of each fastener (**A**). Fasten the cable using a hex key (**B**).

NOTE: Make sure to tighten the fasteners very well to avoid any damage. Trim any excess cables.

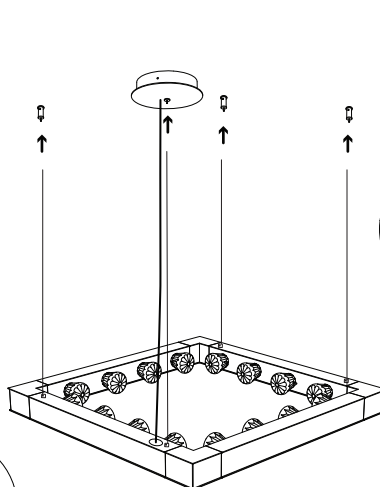

Once the suspension cables are securely fastened to the lamp, guide the other end of each cable through the cable fastener nozzles.

NOTE: Canopy cable fasteners work the same way as our individual ceiling cable fasteners. The manual for their use is enclosed in this document.

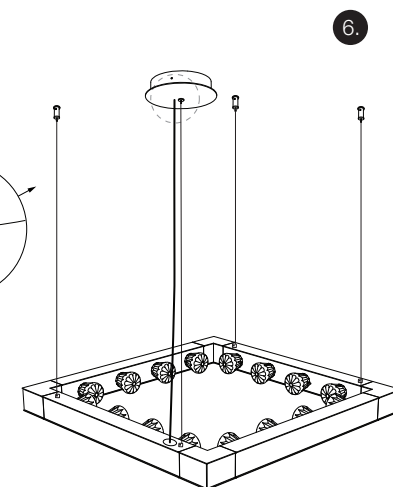

Adjust the level or angle of the lamp with the nozzles until the desired composition is achieved. Tuck away any excess electricity wire in the canopy. Trim any excess suspension cables if necessary. Fixture is ready to use.

CONTACT

JSPR
T +31 (0) 402692111
INFO@JSPR.EU
WWW.JSPR.EU

1.

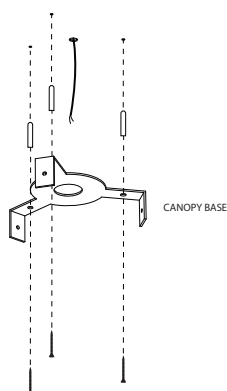

Mark holes in the ceiling based on canopy measurements. Attach canopy base plate using screws and plugs (by client).

2.

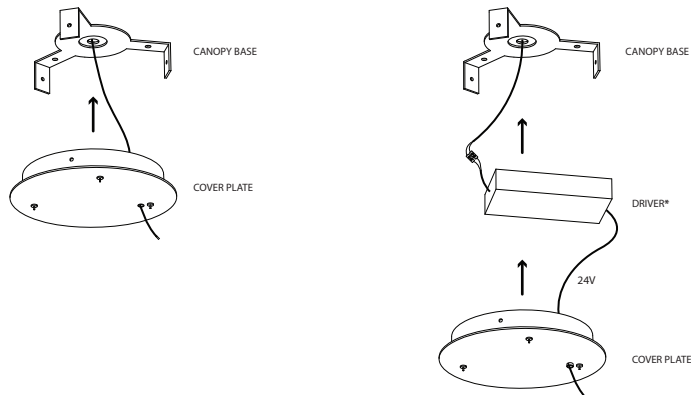

ASSEMBLY WITHOUT DRIVER
Pull through cover plate the house electricity cable or connect the lamps electric cable (through cover plate) to the house electricity wire.

ASSEMBLY WITH DRIVER*
Connect the transformer/driver (220V/110V to 24V*) to the house electric wire. Pull the low voltage wire coming from the transformer through the canopy cover plate.

*depending on lamp

3.

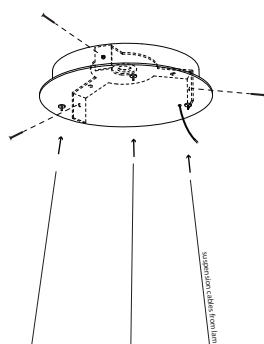

Fix cover plate to the base plate with three included screws. Once tightly fixed proceed to hanging the lamp by guiding the lamps suspension cables through the little nozzles.

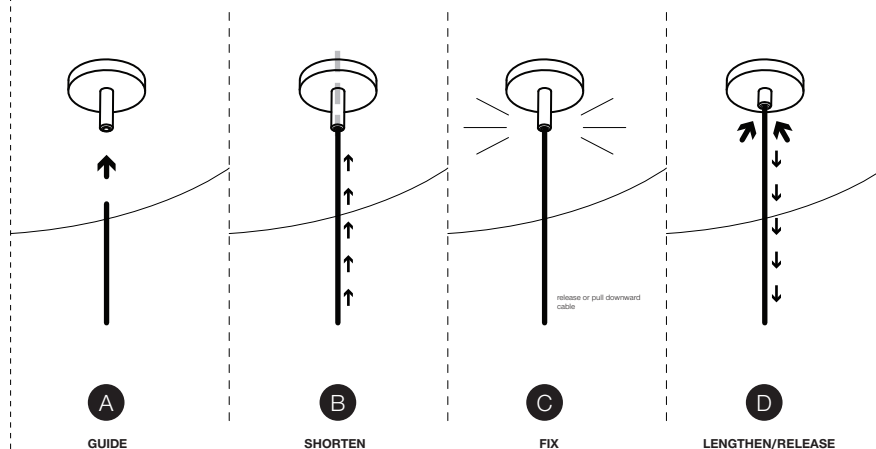

GUIDING THE CABLE (Steps A; B; C)

Guide the support cable through the tinny nozzle (A & B). Once reached the desired length of the cable let it go or pull the cable downwards and the fastener will automatically lock (C).

EXTENDING THE CABLE (Step D)

To extend the cable, push the little nozzle upwards/inside. The cable will loosen and allow to be pulled out. To lock position - release the nozzle and the fastener will automatically lock the cable (Step C).

CONTACT

JSPR
T +31 (0) 402692111
INFO@JSPR.EU
WWW.JSPR.EU

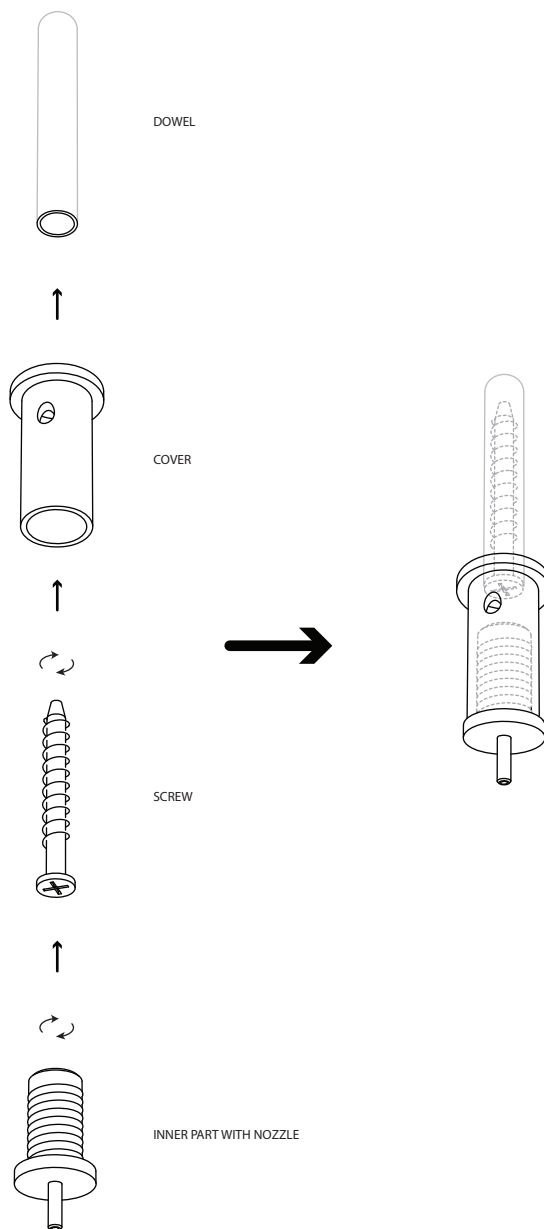

Drill hole in the desired location in the ceiling, place a dowel in the hole (dowel and screw by client). Fasten the cover of the cable fastener with a screw by guiding it through the cover into the dowel. Once the cover is fastened screw in the inner part of the cable fastener.

Proceed to the next page of this manual for information on using this cable fastener.

CONTACT

JSPR
T +31 (0) 402692111
INFO@JSPR.EU
WWW.JSPR.EU

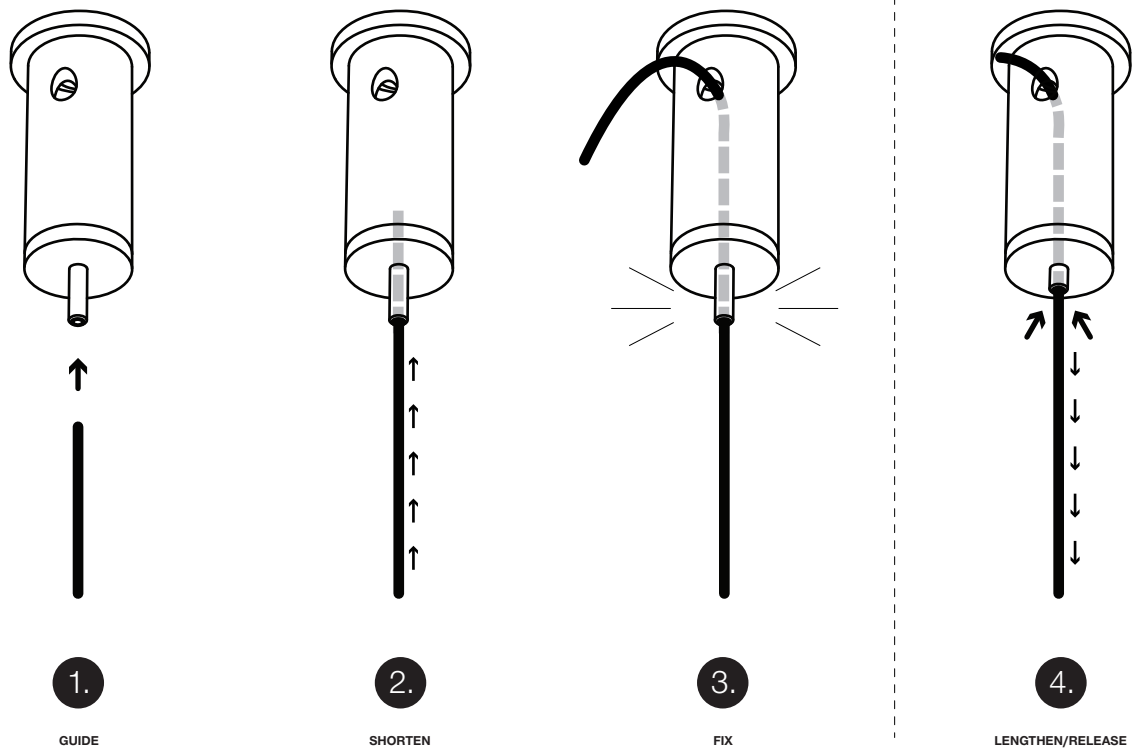

GUIDING THE CABLE (Steps **1 - 3**)

Once the cable fasteners are securely attached to the ceiling, guide the support cable through the tinny nozzle (**1 & 2**). Once reached the desired length of the cable let it go or pull cable downwards and the cable fastener will automatically lock (**3**).

EXTENDING THE CABLE (Step **4**)

To extend the cable, push the little nozzle upwards/inside, the cable will loosen and allow to be pulled out. To fix release the nozzle and the fastener will automatically lock the cable.

After achieving desired length of the lighting fixture trim any excess cables.

CONTACT

JSPR
T +31 (0) 402692111
INFO@JSPR.EU
WWW.JSPR.EU

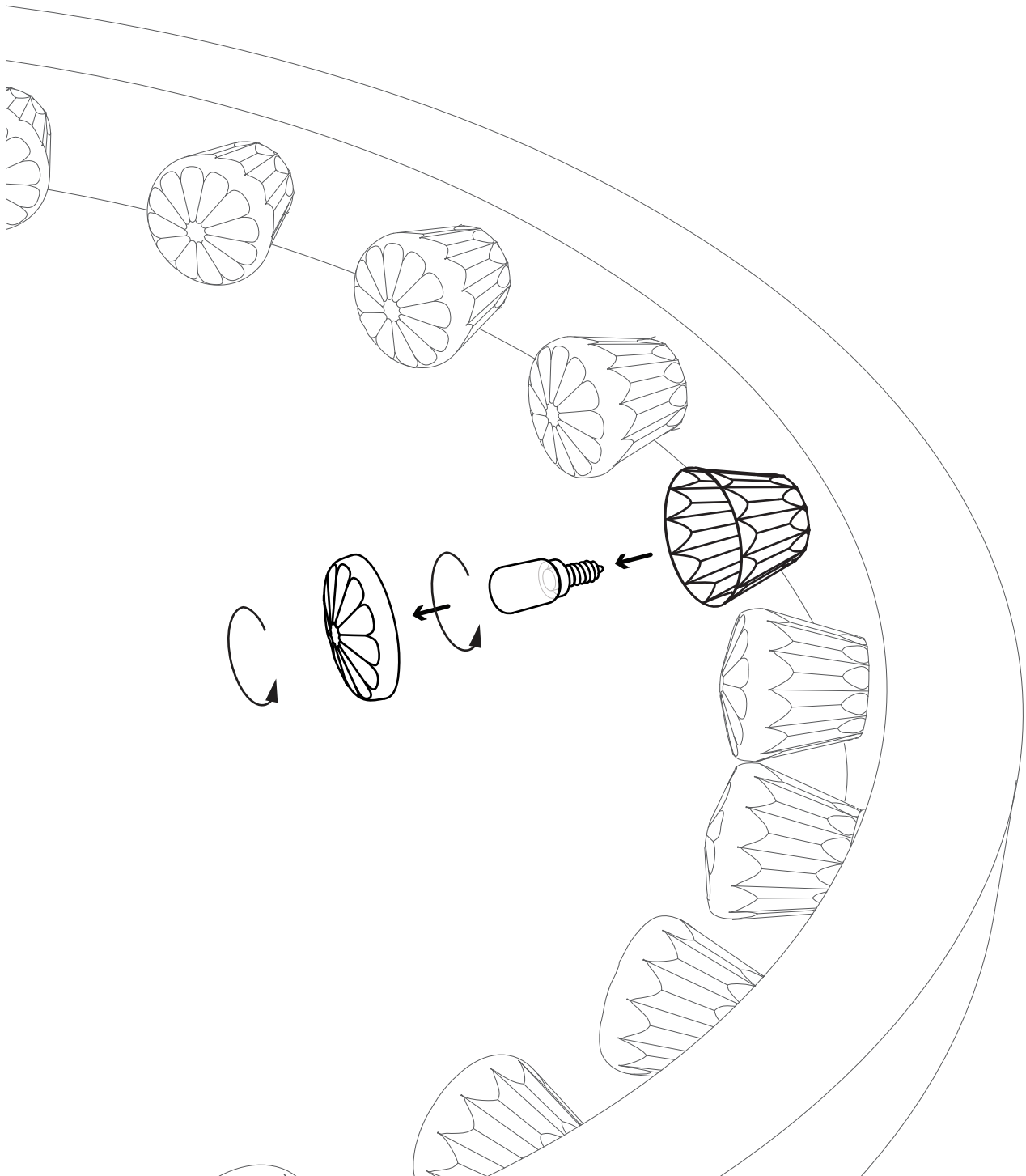

Gently unscrew the top cap and replace LED/bulb.

Fitting: E14

CONTACT

JSPR
T +31 (0) 402692111
INFO@JSPR.EU
WWW.JSPR.EU