

1.

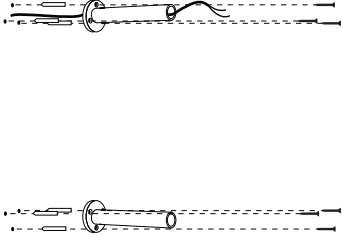

Mark and drill holes in the wall near the house electricity wire, based on lamp size. Attach the brackets using screws and dowels (by client) and pull through the electricity wire through one of the brackets as pictured.

2.

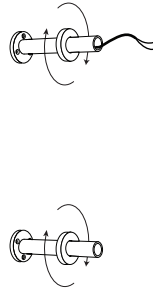

Once the brackets are attached to the wall, screw on the cover caps.

3.

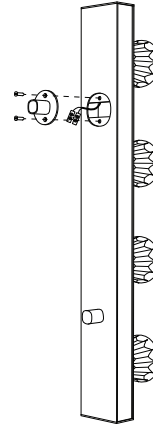

Open the cap on the lamp by unscrewing the top screws. Carefully locate the lamp's wire dock.

4.

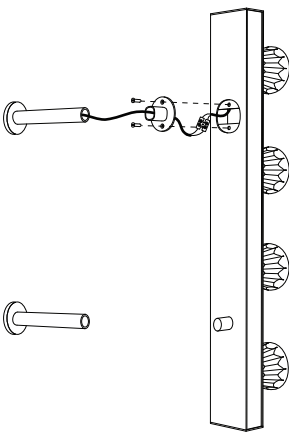

Connect the house electricity wire to the lamp. Tuck away any excess wire in the fixture and attach the cap back to the lamp.

5.

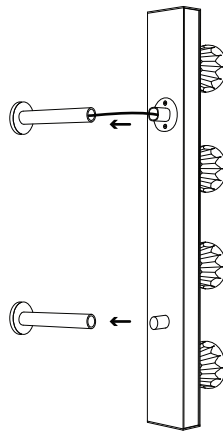

Slide the light fixture on the brackets by carefully aligning the top and bottom bracket to the lamp.

6.

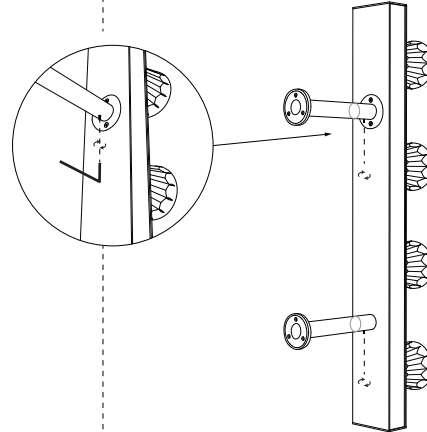

Fasten the fixture to the brackets by fastening the small hex screws located on the bottom of each bracket. The lamp is ready.

CONTACT

JSPR
T +31 (0) 402692111
INFO@JSPR.EU
WWW.JSPR.EU

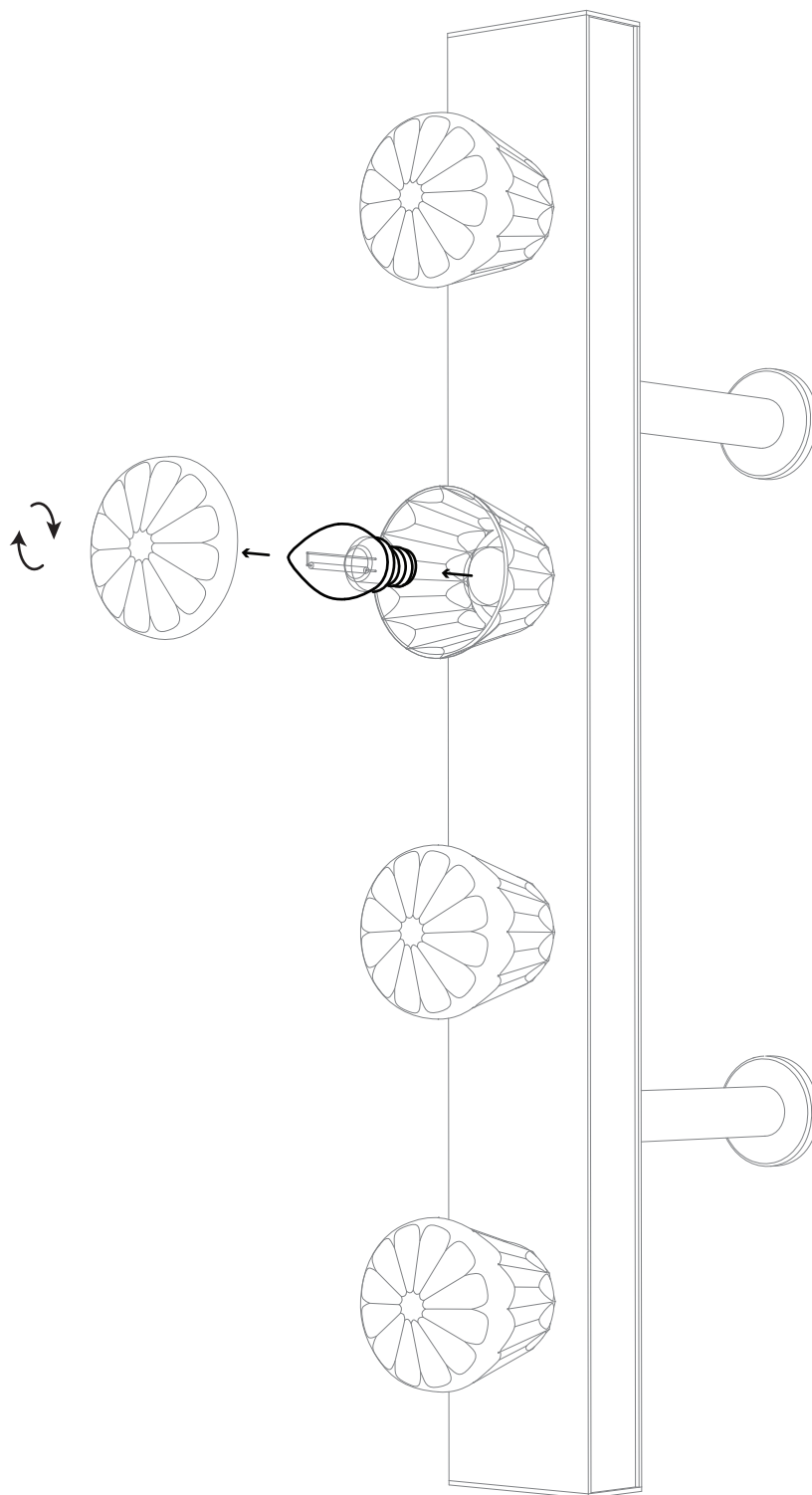

Gently unscrew top cap and replace LED bulb.
Fitting: E14

CONTACT

JSPR
T +31 (0) 402692111
INFO@JSPR.EU
WWW.JSPR.EU